

Lightning Arrester TYPE 1

TYPE 1

SPARK GAP

TYPE 1 / CLASS I / CE

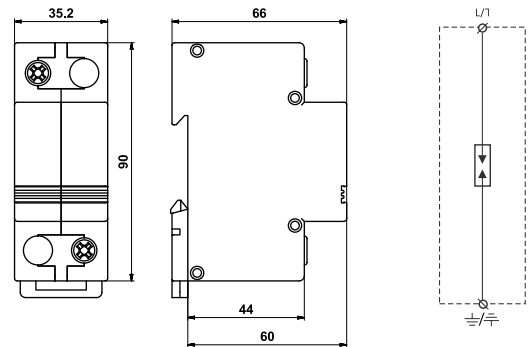

PZH R1 255/50, PZH R1 440/50

PZH R1* is a lightning arrester according to standard EN 61643-11 ed.2 (IEC 61643-11:2011) consisting of multiple non-exhausting spark gaps. Its parameters enable usage in buildings with a considerable level of protection LPL I, such as big industrial complexes and properties of particular importance – hospitals, banks, power plants or buildings with explosion danger. The device is to be installed on the interface of LPZ 0 – LPZ 1 zones according to standard EN 62305 ed.2 (IEC 62305:2010), closest to where the overhead line enters the building i.e. the electric power substation, electrometer or the main distribution boards.

TYPE		PZH R1 255/50	PZH R1 440/50
Test class according to EN 61643-11 ed.2 (IEC 61643-11:2011)		TYPE 1, CLASS I	
Max. continuous operating voltage	U_c	255 V AC	440 V AC
Impulse discharge current for class I test (10/350)	I_{imp}	50 kA	
Charge	Q	25 As	
Specific energy	W/R	600 kJ/Ω	
Nominal discharge current for class II test (8/20)	I_n	50 kA	
Voltage protection level at I_{imp}	U_p	< 2 kV	< 2,5 kV
Temporary overvoltage (TOV)	U_T	337 V/5 s	581 V/5 s
Response time	t_A	< 100 ns	
Follow current interrupt rating	I_{fi}	3 kA _{rms}	
Max. back-up fuse		500 A gL/gG	
Short-circuit withstand capability 500 A gl/gG	I_p	25 kA _{rms}	
LPZ		0-1	
Housing material		Polyamid PA6, UL94 V-0	
Degree of protection of enclosure		IP20	
Operating temperature range	g	-40°C ... +70 °C	
Cross-section of the connected conductors (at tightening moment of clamps 3 Nm)		35 mm ² (solid) - 25 mm ² (wire)	
The mounting method / operating position		DIN rail 35 mm / any	
Lifetime		min. 100 000 h	
Weight		235 g	
Article number		77 10 970	77 10 950